

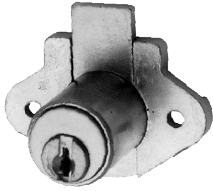

Drawer Locks



02063
DRAWER LOCK
 Pin Tumbler
 Can be Masterkeyed
 Material: Pressure Cast Case, Steel
 Backplate and Bolt, Brass Cylinder and Plug

- 02063-RO783-7/8-US4



02067
CABINET LOCK
 Disc Tumbler
 Can be Masterkeyed
 Material: Brass Plated Steel Backplate & Bolt, Pressure Cast Cylinder
 Operation: Reversible for either hand door
 Rekeying: Plug removal access hole added to allow for removal of plug assembly for rekeying purposes. To remove plug, insert key and rotate 90 degrees. Insert end of small tool (e.g., paper clip) into access hole and depress retainer while pulling key and plug out.

- 02067-7/8-KA-26D
- 02067-7/8-KA-US4
- 02067-7/8-KD-26D
- 02067-7/8-KD-US4
- 02067-3/4-KA-26D
- 02067-3/4-KA-US4
- 02067-3/4-KD-26D
- 02067-3/4-KD-US4
- 02067-1-1/8-KA-26D
- 02067-1-1/8-KA-US4
- 02067-1-1/8-KD-26D
- 02067-1-1/8-KD-US4

The keyed alike locks on this page all use the **CAT30** key number



02068 & 02068 1/2
DRAWER LOCKS
 Disc Tumbler
 Cannot be Masterkeyed*
 Material: Brass Plated Steel Backplate, Cylinder and Bolt, Pressure Cast

- 02068-7/8-KA-US4
- 02068-7/8-KD-US4
- 02068-1/2-7/8-KA-US4
- 02068-1/2-7/8-KD-US4

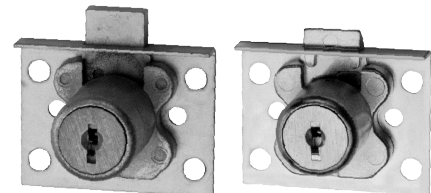

02065 & 02065 1/2
DRAWER LOCKS
 Disc Tumbler
 7/8" Can be Masterkeyed, 1-1/8" Cannot be Masterkeyed*
 Material: Brass Plated Steel Backplate, Cylinder and Bolt, Pressure Cast

- 02065-7/8-KA-26D
- 02065-7/8-KA-US4
- 02065-7/8-KD-26D
- 02065-1-1/8-KD-US4
- 02065-1-1/8-KA-26D
- 02065-1-1/8-KA-US4

- 02065-1/2-7/8-KA-26D
- 02065-1/2-7/8-KA-US4
- 02065-1/2-7/8-KD-26D
- 02065-1/2-7/8-KD-US4

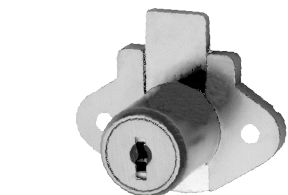

02066
DRAWER LOCK
 Disc Tumbler
 Can be Masterkeyed
 Material: Brass Plated Steel Backplate and Bolt, Pressure Cast Cylinder

- 02066-7/8-KA-26D
- 02066-7/8-KA-US4
- 02066-7/8-KD-26D
- 02066-3/4-KA-26D
- 02066-3/4-KA-US4
- 02066-3/4-KD-26D
- 02066-3/4-KD-US4
- 02066-1-1/8-KA-26D
- 02066-1-1/8-KA-US4
- 02066-1-1/8-KD-26D
- 02066-1-1/8-KD-US4



Cam Locks

**15751 & 15760
CAM LOCKS**
Disc Tumbler
Can be Masterkeyed
Material: Pressure cast

- B15751-5/8-KD-26D
- B15751-KA-CAT30-26D
- B15760-KA-CAT30-26D
- B15760-KD-26D

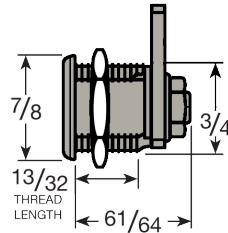

15751

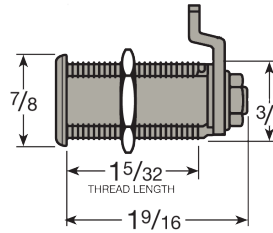

15760

MOUNTING CUTOUT

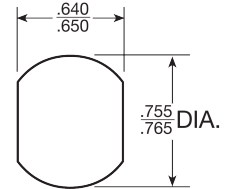

Cam Rotation: Regular rotation 90 degrees from 12 to 9 o'clock, key removable only in locked position at 12.

Cam Positions: Regularly furnished with cam mounted at 12 o'clock locked position. Cam may be mounted at 3, 6, 9, or 12 o'clock locked position.

Padlocks

2470 STANDARD COMBINATION PADLOCK

Combination: 3 dials,
1,000 possible combinations

- 2470-BN

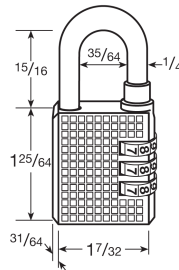

3470 TRADITIONAL COMBINATION PADLOCK

Combination: 3 dials,
1,000 possible combinations

- 3470-BN

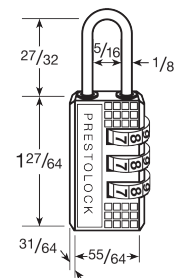

K436, K437, K500 SERIES CCL - Sesamee, "the padlock without a key",

means strength and simplicity in locking security. Choose from 10,000 possible combinations which can be easily changed and set. Heel and toe locking. All brass internal locking mechanism. Automatic "0000" stop. Full instructions furnished.

- K436 (A=1")
- K437 (A=2-1/4")
- K500-2-1/4
- K500-3/4

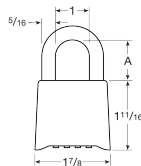

66 Series HUSKI™ PADLOCKS

Material: Solid pressure cast, textured military green matte finish.

Hardened steel, chrome plated shackle.

66R: 2 3/4" shackle with tag and clevis

- 66-KA-AUE1
- 66-KA-AUE50
- 66-KD
- 66R-KA-AUE1
- 66R-KD

